

# MARK™ 2.0

## INSTALLATION INSTRUCTIONS



**⚠ WARNING:** Over-torquing fasteners can damage your mount and will not be covered by warranty.

### **⚠ BEFORE INSTALLATION**

Carefully remove 3M Peltor™ headset from headband assembly. Cutting open OEM headband to free joining cable may be necessary. Exercise caution to not damage cable.

- 1** Pivot headband stems from 90° on ear cups to line up with flats on posts.
- 2** Pop stems off posts. Be careful not to damage C-Clamps.
- 3** Turn stems 90° on wire forms and pull off wires. Failing to turn stems first may result in damage to stems.
- 4** Reassemble in reverse order on MARK 2.0 wire forms.

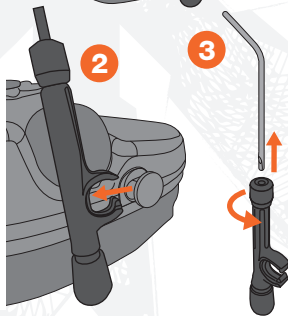
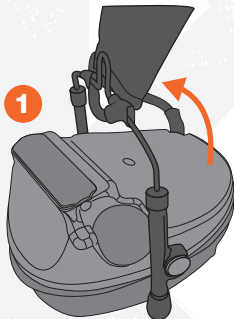

# MARK<sup>TM</sup> 2.0

## INSTALLATION INSTRUCTIONS



**⚠ WARNING:** Over-torquing fasteners can damage your mount and will not be covered by warranty.

### Ops-Core ARC<sup>TM</sup> and Similar

The ARC<sup>TM</sup> Adapter Plates are designed to work with genuine Ops-Core ARC<sup>TM</sup> Rail. They are also compatible with similar rails, but may require slight fitting. If the ARC<sup>TM</sup> Adapter is too tight in a non-Ops-Core rail, carefully remove material with a fine grit sandpaper until optimal fit is achieved.

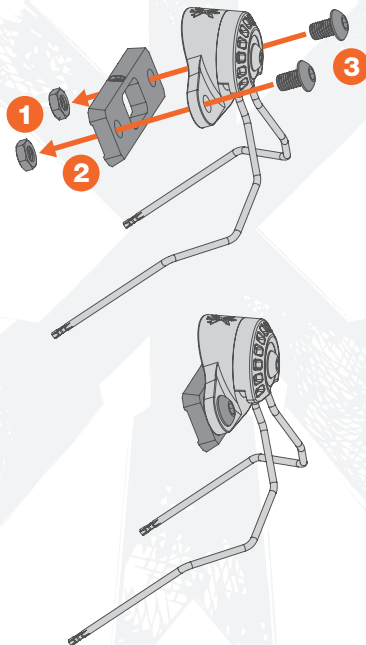

- 1** Install 2x Nuts into the ARC<sup>TM</sup> Adapter as shown.
- 2** Slide ARC<sup>TM</sup> Adapter assembly onto ARC<sup>TM</sup> rail.
- 3** Using 10-32 x 5/16 Screws (shorter included screws), secure MARK 2.0 assembly to the backer. Lightly snug both screws before applying torque to either. DO NOT EXCEED 10 IN-LBS.

# MARK™ 2.0

## INSTALLATION INSTRUCTIONS



**⚠ WARNING:** Over-torquing fasteners can damage your mount and will not be covered by warranty.

### Team Wendy EXFIL™ Rails

The Team Wendy EXFIL™ 2.0 and 3.0 Helmet Rails have an accessory cover that must be removed before installation of MARK 2.0. Remove the accessory cover and 2x OEM hardware. Place them in a safe location in case they are re-installed at a later time. Leave the accessory filler plate in place.

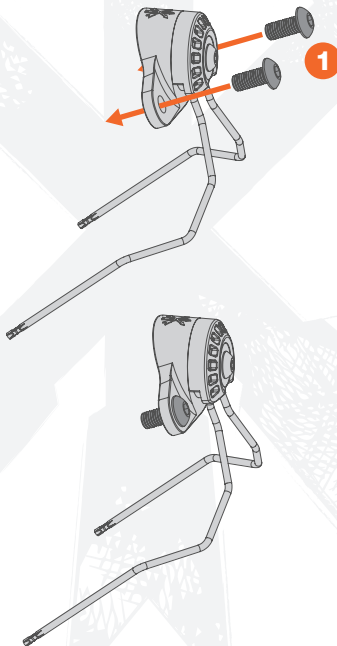

- 1 Using 10-32 x 7/16 Screws (Longer included screws), secure MARK 2.0 assembly to the rail. Lightly snug both screws before applying torque to either. DO NOT EXCEED 10 IN-LBS.

# MARK<sup>TM</sup> 2.0

## INSTALLATION INSTRUCTIONS



**⚠ WARNING:** Over-torquing fasteners can damage your mount and will not be covered by warranty.

### M-LOK<sup>TM</sup> Rails

The M-LOK<sup>TM</sup> MARK 2.0 Accessory Kit is sold separately.

- 1** Install the M-LOK<sup>TM</sup> Nuts and 10-24 x 3/8 screws included in the MARK 2.0 M-LOK<sup>TM</sup> Accessory Kit through the MARK 2.0 body.

- 2** Secure MARK 2.0 assembly to M-LOK<sup>TM</sup> helmet rail using normal M-LOK<sup>TM</sup> mounting procedures. Lightly snug both screws before applying torque to either. DO NOT EXCEED 10 IN-LBS.

