

PRODUCT IDENTIFICATION

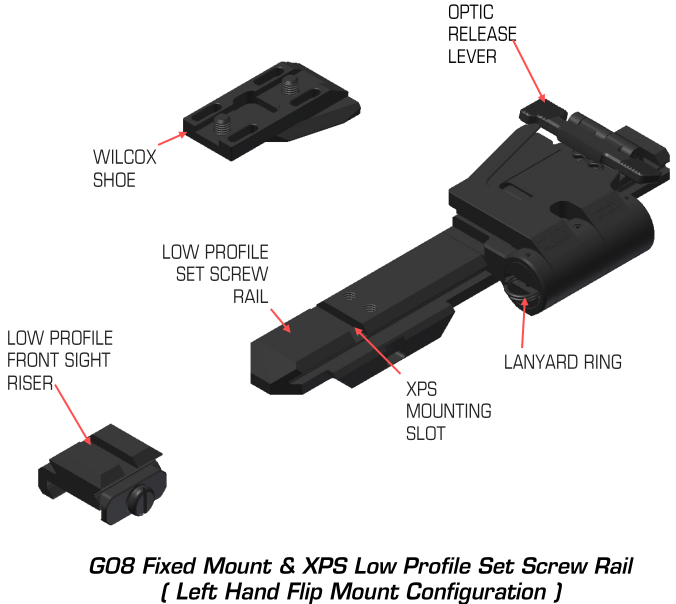

ADJUSTMENT RANGES

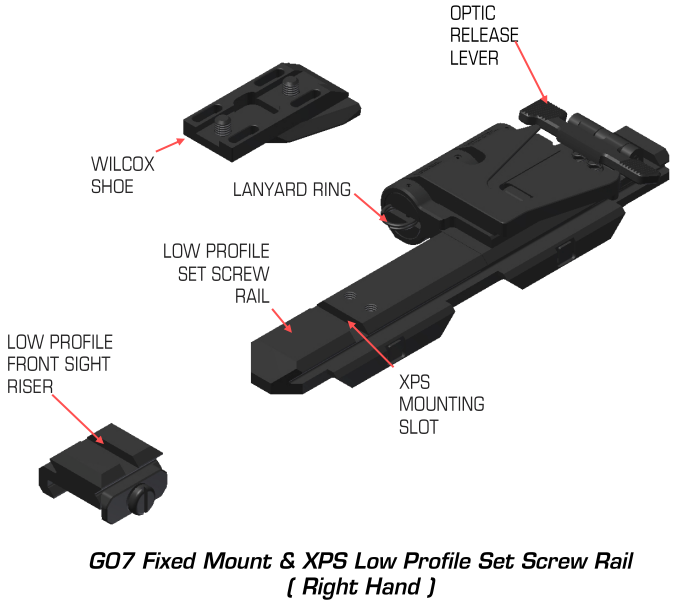
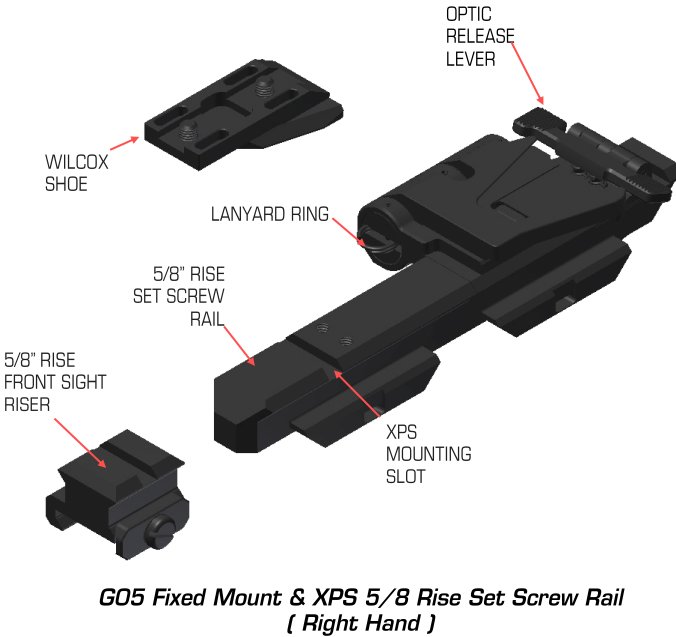
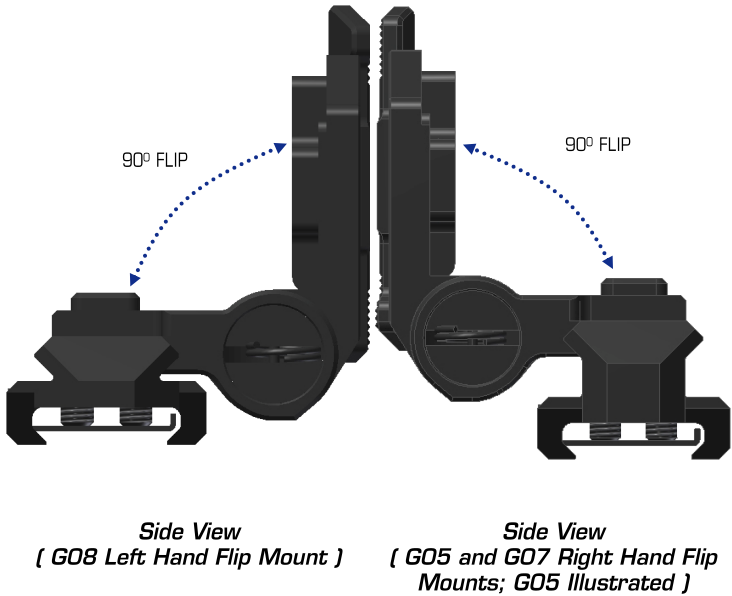

STANDARD LIMITED WARRANTY

For full warranty terms, contact Wilcox Customer Service at 603-431-1331.

WARRANTY CLAIM AND SERVICE INFORMATION

Wilcox must be contacted in the United States at (603) 431-1331 to assign a **Return Merchandise Authorization (RMA) / Service Call Number (SC)** prior to return shipment.

After an RMA/SC number is provided, Wilcox will accept a package at the address below, clearly marked with the number assigned as follows:

**Wilcox Industries Corp.**  
**RMA # \_\_\_\_\_**  
**25 Piscataqua Drive**  
**Newington, NH 03801**

The product must be securely packaged, accompanied by purchasing information, a letter including sender's name, address, daytime phone number, date of manufacture, lot number and a description of the problem or work to be performed.

Flip mechanisms that are not kept free from debris may bind and the assembly may not lock the mount into the deployed or stowed position. Lubricate lightly as needed.

Clean the Mount by flushing away dirt with fresh water and/or wiping down the assemblies with a clean, damp cloth. If used in a salt water environment, flushing with fresh water and drying after use is recommended. If used extensively in a salt water environment, lightly lubricate stainless steel parts as needed.

CARE AND MAINTENANCE

*“Our Customer's Life Depends on It”™*

Manufactured by:  
**WILCOX®**  
Wilcox Industries, Corp.  
25 Piscataqua Drive  
Newington, NH 03801-7816  
Phone: +1 888-8WILCOX  
+1 603-431-1331  
Fax: +1 603-431-1221  
[QR Code]  
[YouTube] [Facebook] [Instagram] [Twitter]  
**WWW.WILCOXIND.COM**  
For troubleshooting service questions,  
contact Wilcox between 8am and 5pm EST.

**When performing operations that could cause entanglement, ensure that the flip feature is not obstructed in any way.**

CAUTION

GENERAL SAFETY WARNINGS

OPERATION AND MAINTENANCE  
INSTRUCTIONS FOR THE  
**WILCOX®**  
**G05, G07 and G08 Fixed Flip Mounts for the**  
**EOTech G23 Magnifier and XPS Systems**  
**CAGEC: 004F1**

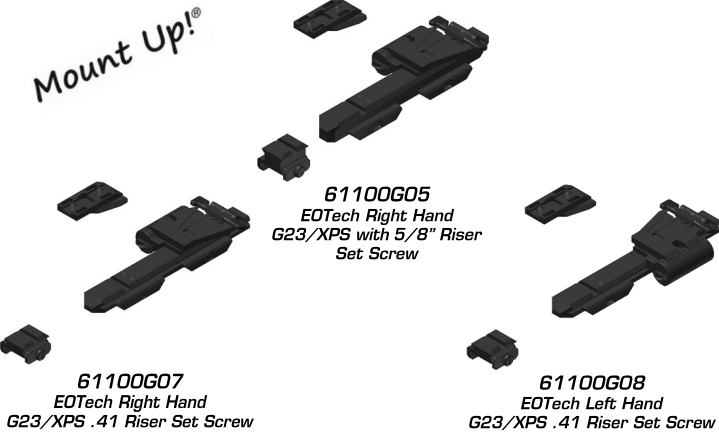

© 2012-2022 Wilcox Industries Corp. All rights reserved. Printed in USA. Wilcox's line of EOTech Mounting Systems is Patent Pending. US Patent 8,978,539. Wilcox®, "Mount Up!" and the Wilcox "X" logo are federally registered trademarks of Wilcox Industries Corp. "Our Customer's Life Depends on It" is a trademark of Wilcox Industries Corp. XPS is a trademark of L-3 Communications EOTech Inc. All other trademarks and registered trademarks in this manual are the property of their respective companies. Specifications and other data are subject to change without notice. **EAR Controlled: Commerce license may be required for export or re-export.**

INSTALLATION

To Attach the Set Screw Style Rails:

- 1. IF PERMANENT INSTALLATION IS DESIRED, APPLY A DROP OF LOCTITE 271 TO THE THREADS OF THE SCREWS, AND SET ASIDE.
- 2. ENSURE THAT THE WEAPON IS SAFE.
- 3. SLIDE THE RAIL ONTO THE TOP WEAPON RAIL FROM THE REAR ENSURING THAT THE MOUNTING GROOVES IN THE MOUNT ALIGN WITH THE OUTER GUIDES ON THE MIL-STD-1913 RAIL.
- 4. INSTALL SHEET METAL TABS TO SECURE THE RAIL TO THE LOCKING GROOVE OF THE MIL-STD-1913 RAIL.
- 5. INSERT THE FOUR SCREWS AND SECURE UNTIL TIGHT USING THE ALLEN WRENCH PROVIDED.
- 6. ENSURE THAT THE RAIL IS PROPERLY MOUNTED BY SLIDING FORWARD AND BACKWARD ON THE RAIL.
- 7. MOUNT THREADED FRONT SIGHT RISER AS INSTRUCTED BELOW FOR THUMB SCREW STYLE RAILS.

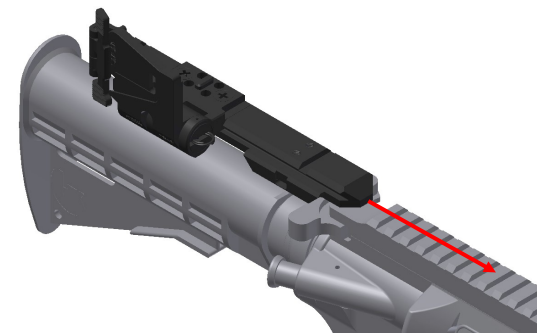

Step 3

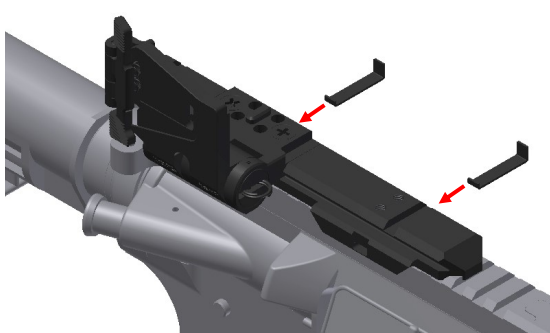

Step 4

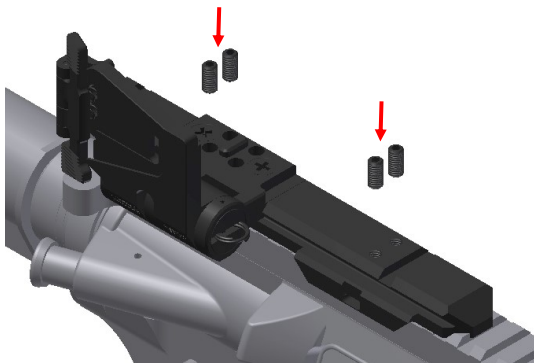

Step 5



Mounted (G07 Right Hand Fixed Flip Mount, Rail Depicted)

To Attach the Front Sight Riser:

- 1. ENSURE THAT THE WEAPON IS SAFE.
- 2. UNTHREAD THE SCREW ASSEMBLIES TO OPEN THE FLOATING RAIL GRABBER.
- 3. ATTACH THE RISER BY SLIDING FROM RIGHT TO LEFT TO ENSURE THAT THE RAIL GRABBER HAS ENGAGED THE MIL-STD-1913 RAIL.
- 4. FROM THE LEFT, SLIDE THE FLOATING RAIL GRABBER TOWARDS THE WEAPON AND SECURE THE SCREW BY ROTATING CW WITH A SCREWDRIVER OR COIN.
- 5. GENTLY PULL ON THE MOUNT TO ENSURE THAT IT IS FULLY SECURE AND THAT THERE IS NO MOVEMENT.

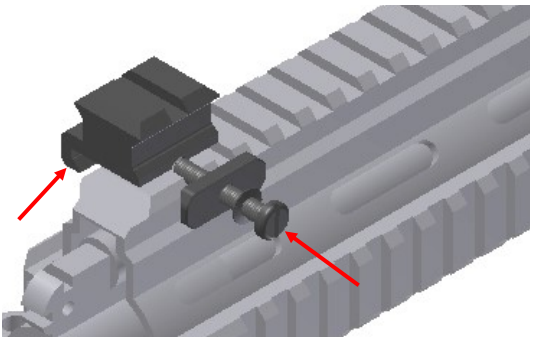

Steps 3 & 4



Recommended Weapon Configuration, Mounted (G07 Fixed Flip Mount Depicted)

To Mount the Wilcox Shoe to the EOTech Magnifier:

- 1. IF PERMANENT INSTALLATION IS DESIRED, APPLY A DROP OF LOCTITE 271 TO THE THREADS OF THE SCREWS, AND SET ASIDE.
- 2. ATTACH THE BOTTOM OF THE WILCOX SHOE TO THE TOP OF THE EOTECH MAGNIFIER INTERFACE, ALIGNING THE HOLES TO THE FRONT OR BACK SET OF SCREWS AS DESIRED.
- 3. INSERT THE SCREWS AND THREAD HAND TIGHT WITH A SCREWDRIVER.

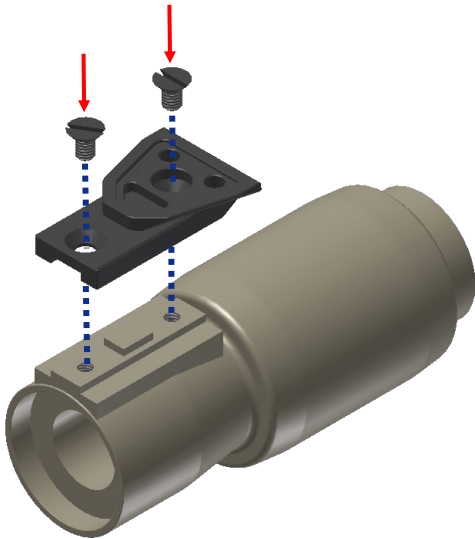

Mounting the Wilcox Shoe to the EOTech Magnifier (Magnifier Not Provided)

To Attach the Magnifier to the Wilcox Flip Mount:

The Flip Mounts provide a locking mechanism that prevents accidental discharge of the optic from the mount.

- 1. DEPRESS THE OPTIC RELEASE LEVER.
- 2. INSERT THE DOVETAIL OF THE SHOE INTO THE INTERFACE OF THE FLIP MOUNT AND PRESS UNTIL THE RELEASE LEVER LOCKS.
- 3. GENTLY PULL ON THE OPTIC TO ENSURE THAT IT IS LOCKED IN PLACE.
- 4. NOTE THAT IT IS BEST TO ATTACH A LANYARD TO THE LANYARD RING PROVIDED TO PREVENT LOSS OF THE OPTIC IN HARSH OPERATING ENVIRONMENTS.
- 5. DEPRESS NVG RELEASE LEVER AGAIN TO RELEASE NVG.

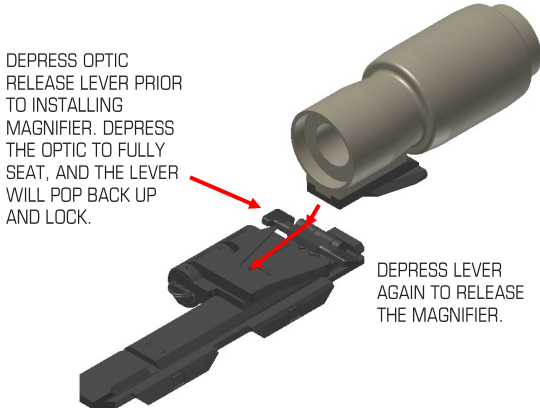

Attaching the Magnifier to the Wilcox Flip Mount (RH Flip Mount Depicted)

OPERATION

To Pivot the Flip Mounts to the Stowed Position the Weapon:

The Flip Mounts for the EOTech G23 features a force to overcome tilt mechanism. To pivot the Flip Mount between the deployed and stowed positions, simply tilt the mount with enough force to overcome the resistance of the mount.

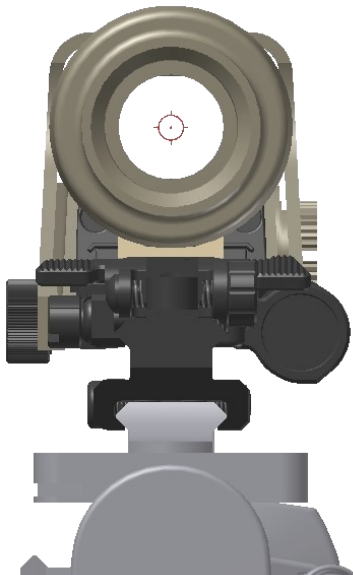

Deployed (RH Flip Mount Depicted)

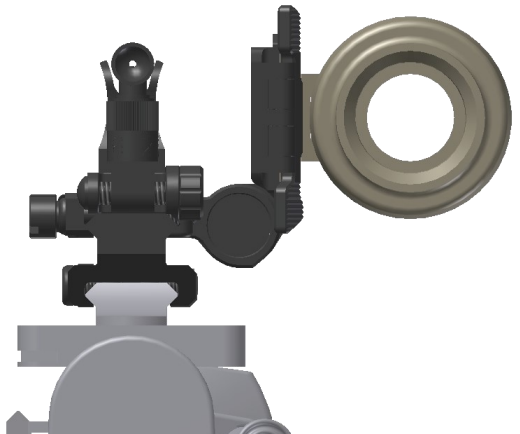

Stowed; Front Sight Mounted to Wilcox Front Rail (RH Flip Mount Depicted)

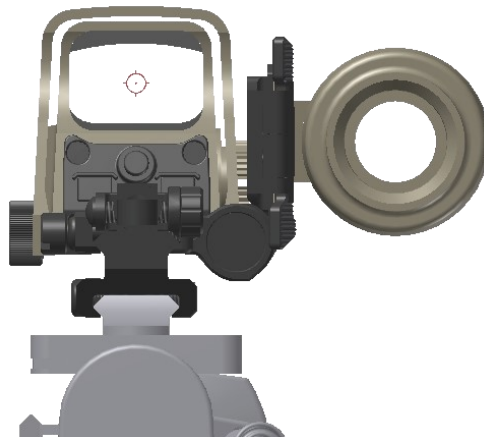

Stowed for Reflex Sight View (RH Flip Mount Depicted)